

**TRAFFIC SWINGING SINGLE LEAF DOORS WITH TORSION HINGES**

ALL PRICES IN EURO, 2 MM THICK DOOR FRAME INCLUDED, VAT NOT INCLUDED

**(TSD TH)**

30.10.2023

- PH Insulation's traffic swinging doors are designed to separate production and other premises in places with intensive traffic of personnel. The factory-made doors are ready for installation on technological, industrial premises, supermarkets, hospitals, food production facilities, cafes, restaurants, etc. Doors can be equipped with oval windows of 200x500 or 300x580 mm.
- PH Insulation's doors with torsion hinges automatically return to the closed position and remain closed even in strong wind.
- All elements of torsion hinges are made of steel.
- Torsion hinges are less visible in the interior compared to standard hinges.

**OVERHEAD FRAME**

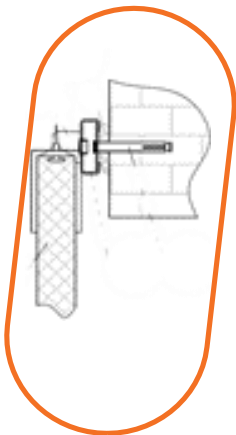

INSTALLATION OPENING, HEIGHT, MM	INSTALLATION OPENING, WIDTH, MM						
	700	800	900	1000	1100	1200	1300
1800	342	349	355	365	372	386	450
1900	346	354	360	371	377	444	456
2000	349	359	365	376	383	450	462
2100	353	364	370	381	439	455	467
2200	356	369	375	386	444	461	473
2300	364	377	384	447	454	472	538
2400	371	386	393	456	464	482	550
2500	436	449	458	471	479	497	567
2600	445	460	468	482	490	564	579
2700	451	466	475	489	498	572	587
2800	456	473	482	496	559	579	595
2900	516	531	541	556	566	587	603
3000	522	538	548	563	573	595	611
3100	526	544	554	569	580	602	618
3200	531	550	560	577	587	609	626
3300	538	558	569	585	596	618	635

RAL 9003

**ANGULAR FRAME**

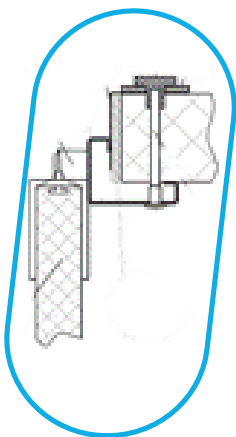

INSTALLATION OPENING, HEIGHT, MM	INSTALLATION OPENING, WIDTH, MM						
	700	800	900	1000	1100	1200	1300
1800	359	368	375	383	390	405	470
1900	364	374	380	389	396	465	477
2000	372	383	390	399	406	476	488
2100	376	388	396	405	465	482	495
2200	380	394	401	411	471	489	502
2300	388	403	411	473	482	500	569
2400	396	413	421	484	493	511	581
2500	459	474	483	494	503	523	593
2600	467	483	492	504	513	587	603
2700	473	490	500	512	521	596	612
2800	479	498	507	519	582	604	621
2900	540	557	567	580	591	613	630
3000	544	562	572	586	596	619	636
3100	550	570	580	594	604	627	645
3200	559	579	590	604	615	638	656
3300	565	587	598	612	623	647	665

RAL 9003

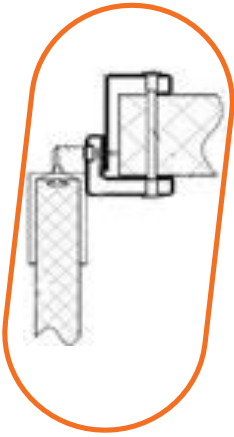
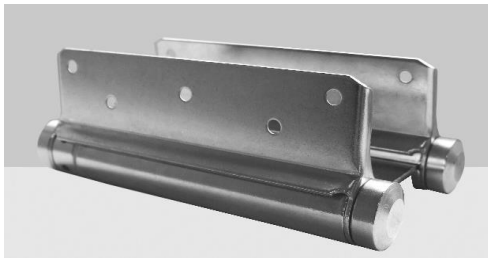

### OVERLAPPING FRAME

INSTALLATION OPENING, HEIGHT, MM	INSTALLATION OPENING, WIDTH, MM						
	700	800	900	1000	1100	1200	1300
1800	423	434	443	453	464	479	540
1900	430	442	451	461	473	544	549
2000	441	454	463	474	486	558	564
2100	448	462	471	483	549	567	573
2200	454	470	479	491	558	576	582
2300	465	483	492	559	572	591	654
2400	477	495	505	573	586	606	670
2500	551	568	579	593	607	627	691
2600	561	580	591	605	619	697	704
2700	570	590	601	616	630	709	716
2800	579	600	612	626	697	720	727
2900	645	664	677	693	709	731	739
3000	648	669	682	698	714	737	744
3100	657	679	692	708	724	748	756
3200	672	695	708	724	741	765	773
3300	681	705	718	735	752	777	785

RAL 9003

OUR DOORS ARE AVAILABLE IN CUSTOM SIZES TO INSURE BEST COMMERCIAL APPLICATION

## TRAFFIC SWINGING DOUBLE LEAF DOORS WITH TORSION HINGES

ALL PRICES IN EURO, 2 MM THICK DOOR FRAME INCLUDED, VAT NOT INCLUDED

(TDD TH)

30.10.2023

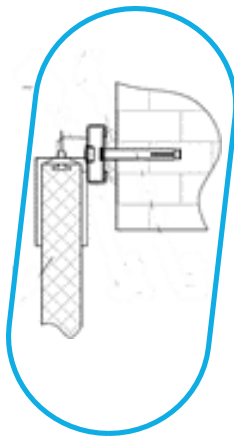

### OVERHEAD FRAME

INSTALLATION OPENING, HEIGHT, MM	INSTALLATION OPENING, WIDTH, MM				
	1000	1100	1200	1300	1400
1800	536	538	544	547	599
1900	542	544	551	553	608
2000	547	550	557	560	617
2100	553	556	563	566	626
2200	559	562	569	572	635
2300	571	574	581	584	651
2400	582	586	593	596	667
2500	691	695	702	706	779
2600	706	709	717	721	797
2700				730	810
2800				740	822
2900				853	938
3000				863	951
3100				871	962
3200				881	975
3300				892	989

RAL 9003

## OVERHEAD FRAME

	INSTALLATION OPENING, HEIGHT, MM	INSTALLATION OPENING, WIDTH, MM				
		1500	1600	1700	1800	1900
RAL 9003	1800	602	604	607	610	612
	1900	611	614	617	619	622
	2000	620	623	626	629	632
	2100	629	632	635	638	641
	2200	639	642	645	648	651
	2300	654	658	661	664	769
	2400	670	674	677	681	787
	2500	782	786	790	793	797
	2600	801	804	808	812	816
	2700	813	817	821	825	829
	2800	826	830	834	838	842
	2900	942	946	951	955	959
	3000	955	959	964	968	972
	3100	967	971	975	980	984
	3200	979	984	988	993	997
	3300	994	998	1003	1008	1012

## OVERHEAD FRAME

	INSTALLATION OPENING, HEIGHT, MM	INSTALLATION OPENING, WIDTH, MM						
		2 000	2 100	2 200	2 300	2 400	2 500	2 600
RAL 9003	1800	615	618	620	623	626	729	732
	1900	625	628	630	734	737	740	743
	2000	635	638	641	744	747	750	753
	2100	645	748	751	755	758	761	764
	2200	654	758	762	765	768	771	774
	2300	773	776	779	783	786	891	895
	2400	790	794	797	801	804	911	914
	2500	800	804	808	811	815	921	925
	2600	820	823	827	934	938	941	945
	2700	833	837	841	948	952	956	959
	2800	846	853	858	862	866	870	874
	2900	963	967	971	975	980	984	988
	3000	976	981	985	989	994	998	1002
	3100	989	993	997	1002	1006	1010	1015
	3200	1002	1007	1011	1016	1020	1025	1029
	3300	1017	1022	1026	1031	1036	1040	1045

## ANGULAR FRAME

	INSTALLATION OPENING, HEIGHT, MM	INSTALLATION OPENING, WIDTH, MM				
		1000	1100	1200	1300	1400
RAL 9003	1800	550	553	559	562	614
	1900	557	560	566	569	624
	2000	563	566	573	576	634
	2100	570	573	580	583	644
	2200	582	585	592	596	660
	2300	594	598	605	608	676
	2400	607	610	618	622	693
	2500	715	719	726	730	804
	2600	727	731	739	743	820
	2700				754	833
	2800				764	847
	2900				878	963
	3000				886	974
	3100				896	987
	3200				909	1003
	3300				920	1017

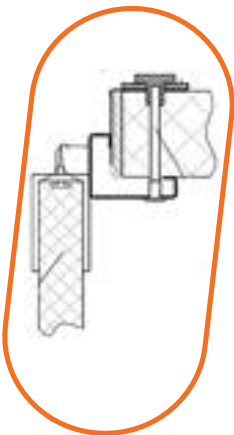

## ANGULAR FRAME

	INSTALLATION OPENING, HEIGHT, MM	INSTALLATION OPENING, WIDTH, MM				
		1500	1600	1700	1800	1900
RAL 9003	1800	617	620	623	626	629
	1900	627	630	633	636	639
	2000	637	640	643	647	650
	2100	647	650	653	657	660
	2200	663	667	670	674	677
	2300	680	683	687	691	797
	2400	697	700	704	708	816
	2500	807	812	815	819	823
	2600	824	828	832	836	840
	2700	837	842	846	850	854
	2800	851	855	860	864	868
	2900	967	972	976	981	985
	3000	979	983	988	992	997
	3100	992	997	1001	1006	1011
	3200	1008	1013	1018	1022	1027
	3300	1022	1027	1031	1036	1041

## ANGULAR FRAME

	INSTALLATION OPENING, HEIGHT, MM	INSTALLATION OPENING, WIDTH, MM						
		2 000	2 100	2 200	2 300	2 400	2 500	2 600
RAL 9003	1800	632	635	638	641	644	747	750
	1900	642	645	648	752	755	758	761
	2000	653	656	659	763	766	770	773
	2100	663	767	771	774	777	781	784
	2200	680	786	789	793	796	800	803
	2300	801	804	808	812	815	922	925
	2400	819	823	827	831	834	942	946
	2500	827	831	835	839	843	950	954
	2600	844	848	852	959	963	967	971
	2700	858	862	867	974	978	982	986
	2800	872	980	984	988	993	997	1001
	2900	990	994	999	1003	1007	1012	1016
	3000	1001	1006	1010	1015	1019	1024	1028
	3100	1015	1020	1025	1029	1034	1039	1043
	3200	1032	1037	1042	1047	1051	1056	1061
	3300	1046	1051	1056	1061	1066	1071	1076

## OVERLAPPING FRAME

	INSTALLATION OPENING, HEIGHT, MM	INSTALLATION OPENING, WIDTH, MM				
		1000	1100	1200	1300	1400
RAL 9003	1800	619	623	631	635	690
	1900	629	633	641	645	703
	2000	639	643	651	656	717
	2100	648	653	661	666	730
	2200	660	665	673	678	745
	2300	676	681	689	694	765
	2400	694	699	708	713	788
	2500	796	801	810	815	891
	2600	811	816	825	830	909
	2700				843	925
	2800				857	942
	2900				975	1063
	3000				982	1073
	3100				995	1088
	3200				1014	1110
	3300				1026	1126

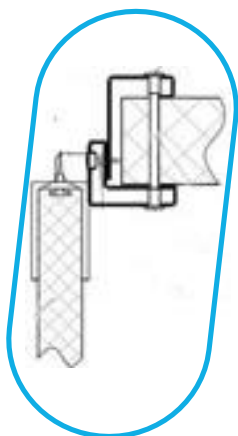

## OVERLAPPING FRAME

	INSTALLATION OPENING, HEIGHT, MM	INSTALLATION OPENING, WIDTH, MM				
		1500	1600	1700	1800	1900
RAL 9003	1800	694	698	702	706	710
	1900	708	712	716	720	724
	2000	721	725	730	734	738
	2100	734	739	743	747	752
	2200	750	755	759	764	768
	2300	770	775	779	784	789
	2400	793	798	803	808	813
	2500	816	821	826	831	836
	2600	840	845	850	855	860
	2700	864	869	874	879	884
	2800	888	893	898	903	908
	2900	912	917	922	927	932
	3000	936	941	946	951	956
	3100	960	965	970	975	980
	3200	984	989	994	999	1004
	3300	1008	1013	1018	1023	1028

## OVERLAPPING FRAME

	INSTALLATION OPENING, HEIGHT, MM	INSTALLATION OPENING, WIDTH, MM						
		2 000	2 100	2 200	2 300	2 400	2 500	2 600
RAL 9003	1800	714	718	722	726	730	839	843
	1900	729	733	737	741	745	854	858
	2000	743	747	751	755	759	869	874
	2100	756	760	764	768	772	884	888
	2200	773	777	781	785	789	901	906
	2300	790	794	798	802	806	916	921
	2400	807	811	815	819	823	931	936
	2500	824	828	832	836	840	946	951
	2600	841	845	849	853	857	961	966
	2700	858	862	866	870	874	976	981
	2800	875	879	883	887	891	991	996
	2900	892	896	900	904	908	1006	1011
	3000	909	913	917	921	925	1021	1026
	3100	926	930	934	938	942	1036	1041
	3200	943	947	951	955	959	1051	1056
	3300	960	964	968	972	976	1066	1071

OUR DOORS ARE AVAILABLE IN CUSTOM SIZES TO INSURE BEST COMMERCIAL APPLICATION

## DOOR CATALOGUE CODES

TSD TH  
TDD TH  
RIGHT / LEFT

TRAFFIC SWINGING SINGLE LEAF DOORS WITH TORSION HINGES  
TRAFFIC SWINGING DOUBLE LEAF DOORS WITH TORSION HINGES  
HINGES ON THE RIGHT / HINGES ON THE LEFT

### EXAMPLE OF DOOR CATALOGUE CODE: TSD TH 800 2000 40 RAL9003/RAL9003 ANG RIGHT

DOOR TYPE	DOORWAY WIDTH	DOORWAY HEIGHT	DOOR THICKNESS	DOOR LEAF METAL		FRAME TYPE	HINGES LOCATION
				EXTERIOR	INTERIOR		
TSD TH	800	2000	40	RAL9003	RAL9003	ANGULAR	RIGHT

## ADDITIONAL OPTIONS FOR TRAFFIC SWINGING DOORS

ITEM	PRICE
TDD FRAME INSTALLATION HARDWARE TO INSULATED SANDWICH PANELS	12
TSD FRAME INSTALLATION HARDWARE TO INSULATED SANDWICH	8
TDD FRAME INSTALLATION HARDWARE TO A BRICK WALL	7
TSD FRAME INSTALLATION HARDWARE TO A BRICK WALL	4
FRAME INSTALLATION HARDWARE FOR STEEL STUD CONSTRUCTION	2
DOOR BLADE MATERIAL: AISI 304, PRICE FOR 1 SQ. M	30
DOOR BLADE MATERIAL: AISI 430, PRICE FOR 1 SQ. M	21
OVERHEAD FRAME AISI 304, PRICE FOR RUNNING METER	17
ANGULAR FRAME AISI 304, PRICE FOR RUNNING METER	29
OVERLAPPING FRAME AISI 304, PRICE FOR RUNNING METER	75
OVERHEAD FRAME AISI 430, PRICE FOR RUNNING METER	10
ANGULAR FRAME AISI 430, PRICE FOR RUNNING METER	17
OVERLAPPING FRAME AISI 430, PRICE FOR RUNNING METER	43
HIDDEN INSTALLATION HARDWARE FOR TSD	41
HIDDEN INSTALLATION HARDWARE FOR TDD	48
HIDDEN INSTALLATION HARDWARE FOR TSD WITH AISI 304 FRAME	56
HIDDEN INSTALLATION HARDWARE FOR TDD WITH AISI 304 FRAME	66
HIDDEN INSTALLATION HARDWARE FOR TSD WITH AISI 430 FRAME	50
HIDDEN INSTALLATION HARDWARE FOR TDD WITH AISI 304 FRAME	59

## FACTORY INSTALLED BUMPERS FOR TSD TH

BUMPER MATERIAL	THICKNESS, MM	PRICE FOR SQ. M	PRICE FOR RUNNING METER	
			BOTTOM 0,25 M	BOTTOM 0,5 M
AISI 304	1,5	100	25	50
AISI 430	1,5	67	17	33
ALUMINIUM CHECKER PLATE	1,5	53	13	26
FLAT HDPE PLASTIC	4,0	30	7	15
CURVED HDPE PLASTIC	6,0	43	11	22

## FACTORY INSTALLED BUMPERS FOR TDD TH

BUMPER MATERIAL	THICKNESS, MM	PRICE FOR SQ. M	PRICE FOR RUNNING METER	
			BOTTOM 0,25 M	BOTTOM 0,5 M
AISI 304	1,5	105	26	53
AISI 430	1,5	69	17	35
ALUMINIUM CHECKER PLATE	1,5	56	14	28
FLAT HDPE PLASTIC	4,0	31	8	15
CURVED HDPE PLASTIC	4,0	35	9	18
CURVED HDPE PLASTIC	6,0	44	11	22

## PACKAGING

ITEM	PRICE
STRETCH-WRAP	INCLUDED IN DOOR PRICE
CARDBOARD PACKAGING	CALCULATED INDIVIDUALLY FOR YOUR ORDER
WOODEN PACKAGING	CALCULATED INDIVIDUALLY FOR YOUR ORDER



PROFHOLOD

+7 (495) 745-01-37

[WWW.PROFHOLOD.COM](http://WWW.PROFHOLOD.COM)